SAW Filter 130.0MHz
Part No: MP03678

Model: TB0972A
Rev No: 1

A. MAXIMUM RATING:

1. Operating Temperature: -10°C ~ 70°C
2. Storage Temperature: -40°C ~ +85°C
3. Input Power Level: 10dBm

B. CHARACTERISTICS:

Ambient Temperature: 25°C

Characteristics	Min.	Typ.	Max.
Center frequency Fc MHz	-	130	-
Minimum Insertion loss IL dB	-	7.0	8.5
1dB Bandwidth kHz	-	145	-
3dB Bandwidth kHz	200	233	250
40dB Bandwidth kHz	-	710	850
Passband Ripple Fc ± 40kHz dB	-	0.5	1.0
Temp Coefficient ppm/K ²	-	-0.036	-

SAW Filter 130.0MHz
Part No: MP03678

Model: TB0972A
Rev No: 1

C. FREQUENCY CHARACTERISTICS:

1. S21 Response

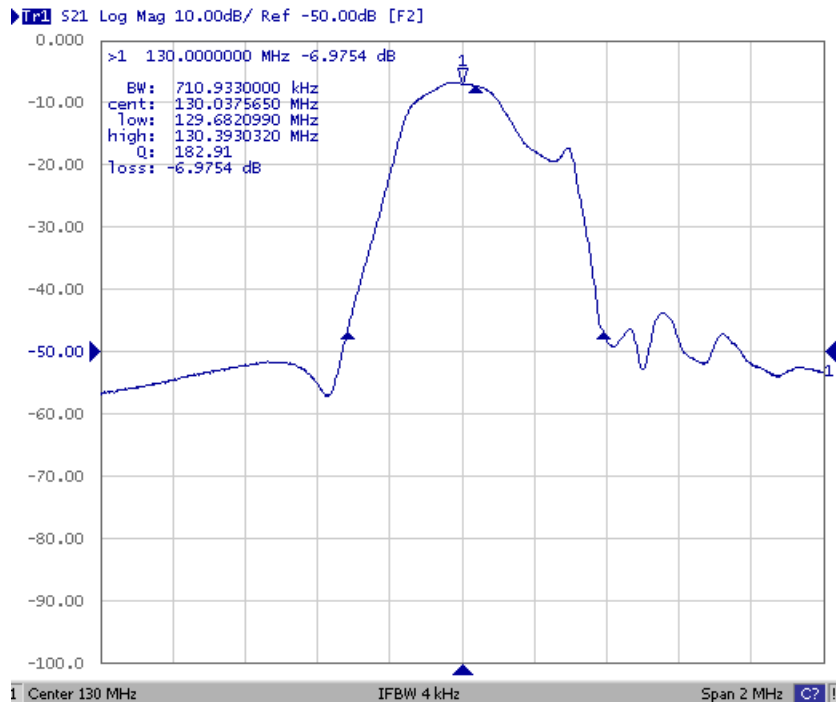

Fig. 1. Horizontal: 0.2MHz/Div, Vertical: 10dB/Div

2. Passband Response and Group Delay Response:

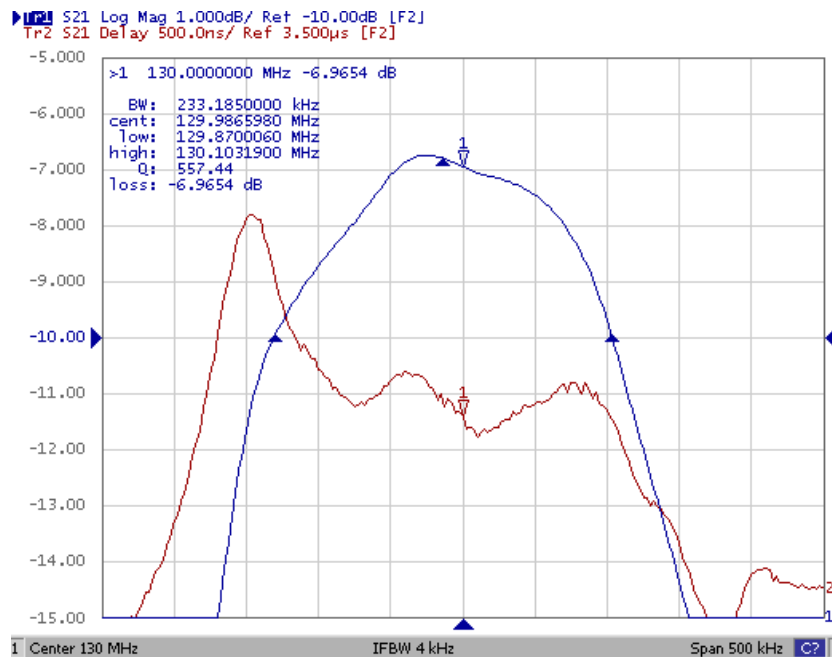
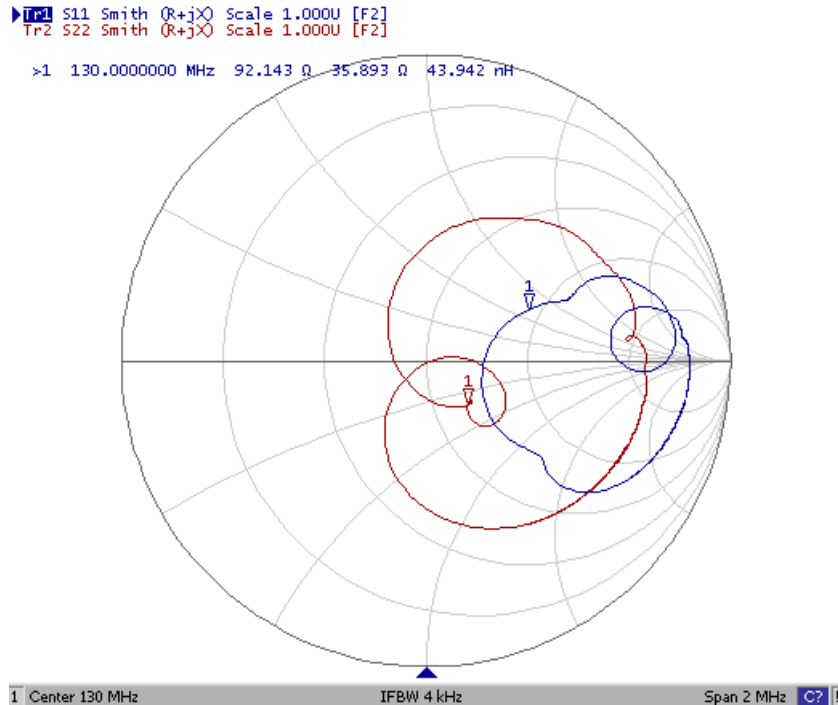

Fig. 2. Horizontal: 0.05MHz/Div, Vertical 1: 1dB/Div, Vertical 2: 500nS/Div

SAW Filter 130.0MHz
Part No: MP03678

Model: TB0972A
Rev No: 1

3. Smith Chart



D. OUTLINE DRAWING:

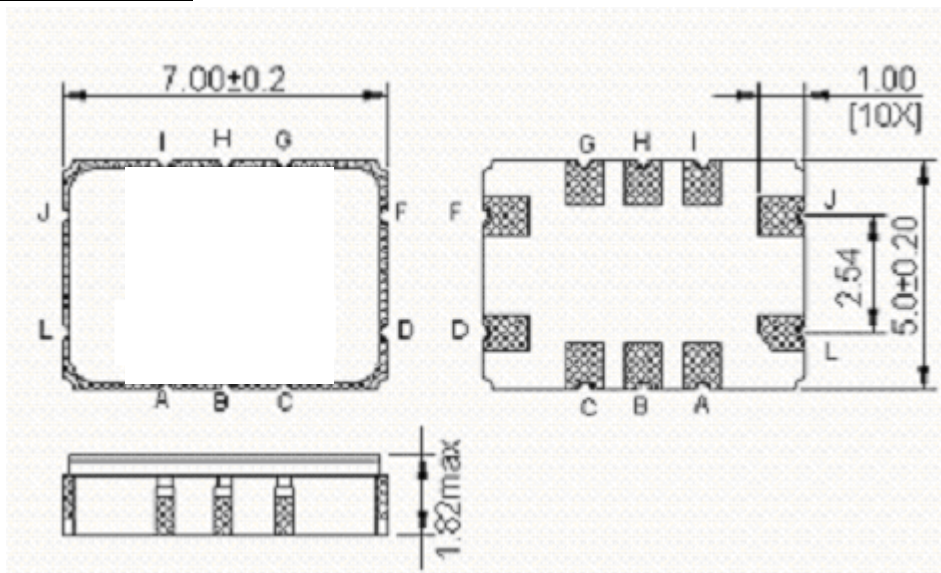

- J: RF input
 - L: RF input ground
 - D: RF output
 - F: RF output ground
 - A, B, C, G, H, I: Ground
- Unit: mm

SAW Filter 130.0MHz
Part No: MP03678

Model: TB0972A
Rev No: 1

E. MATCHING CIRCUIT:

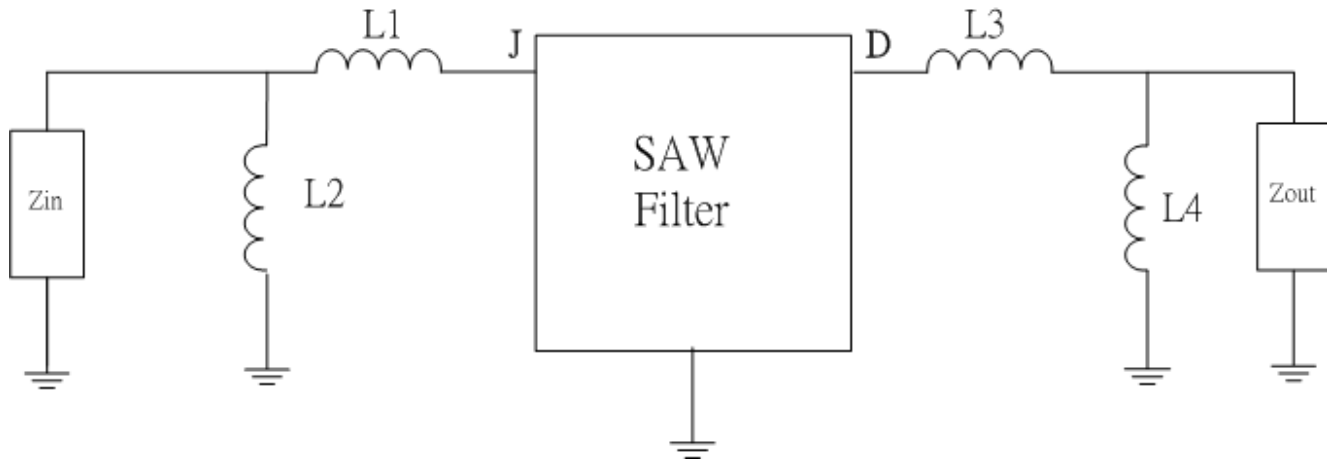

$$Z_{IN} = Z_{OUT} = 50\Omega$$

$$L1 = 12nH + 120nH, L2 = 68nH, L3 = 120nH + 6.8nH, L4 = 47nH$$

F. PCB FOOTPRINT:

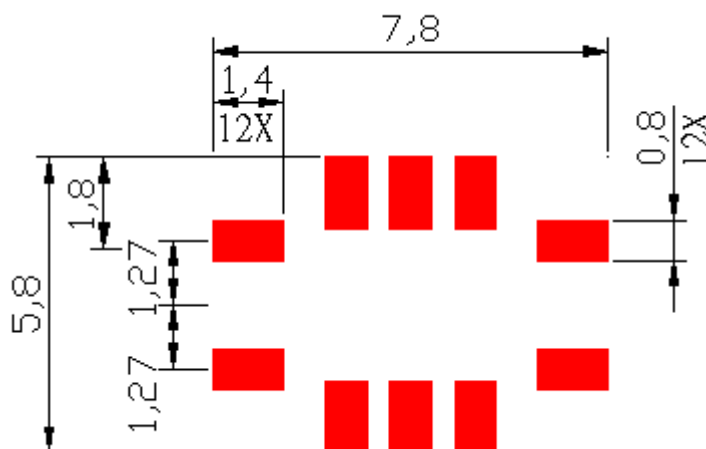

SAW Filter 130.0MHz
Part No: MP03678

Model: TB0972A
Rev No: 1

G. PACKING:

1. REEL DIMENSION

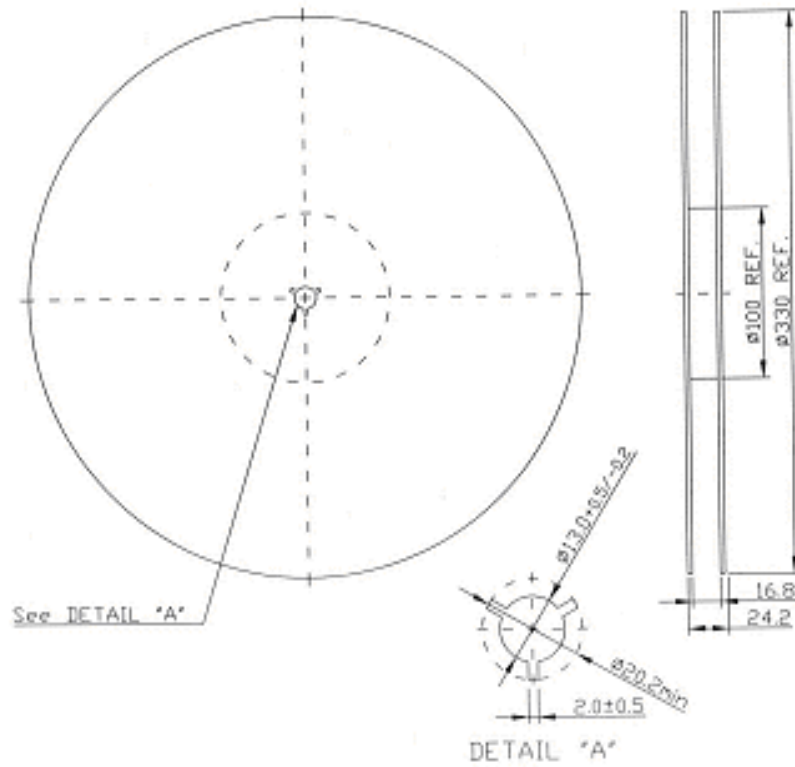

2. TAPE DIMENSION

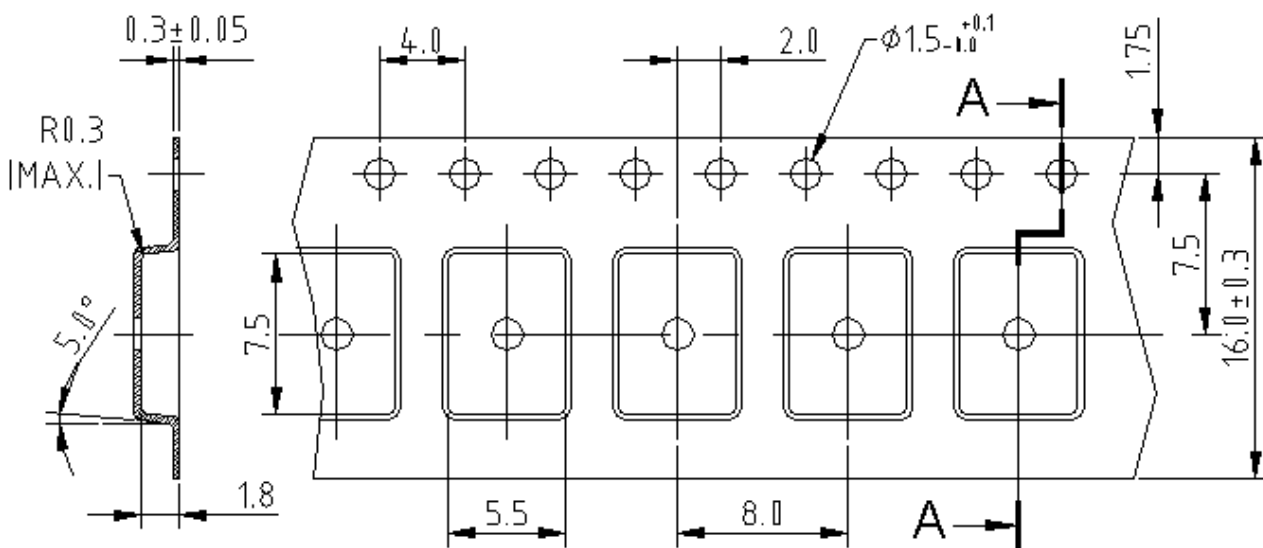

SAW Filter 130.0MHz
Part No: MP03678

Model: TB0972A
Rev No: 1

H. RECOMMENDED REFLOW PROFILE:

