

SAW Filter 120.0MHz
Part No: MP09339

Model: TB1314A
Rev No: 1

A. MAXIMUM RATING:

Electrostatic Sensitive Device

1. Operating temperature range: -40°C to 85°C
2. Storage temperature range: -55°C to 125°C
3. Input Power Level: 10dBm
4. Maximum DC Voltage: 10V
5. Moisture Sensitivity Level: MSL1

B. ELECTRICAL CHARACTERISTICS:

Ambient Temperature: 25°C

Item	Unit	Min.	Typ.	Max.
Center frequency Fc	MHz	-	120	-
Insertion Loss IL	dB	-	5.6	7.0
1dB bandwidth	MHz	0.40	0.66	-
Passband Ripple Fc ±0.2MHz	dB	-	0.4	1.0
Group Delay variation Fc ±0.1MHz	ns		120	200
Absolute Group Delay	us	-	1.20	-
Return Loss	dB	-	10	-
Attenuation: (Reference level from Min IL)				
Fc -1.1MHz ~ Fc -20MHz	dB	35	44	-
Fc +1.1MHz ~ Fc +3MHz	dB	30	32	-
Fc +3MHz ~ Fc +20MHz	dB	35	45	-
Temperature Coefficient	ppm/°C ²	-	-0.032	-
Source Impedance	Ohm	-	50	-
Load Impedance	Ohm	-	50	-

SAW Filter 120.0MHz
Part No: MP09339

Model: TB1314A
Rev No: 1

C. FREQUENCY CHARACTERISTICS:

1. Wide band Response:

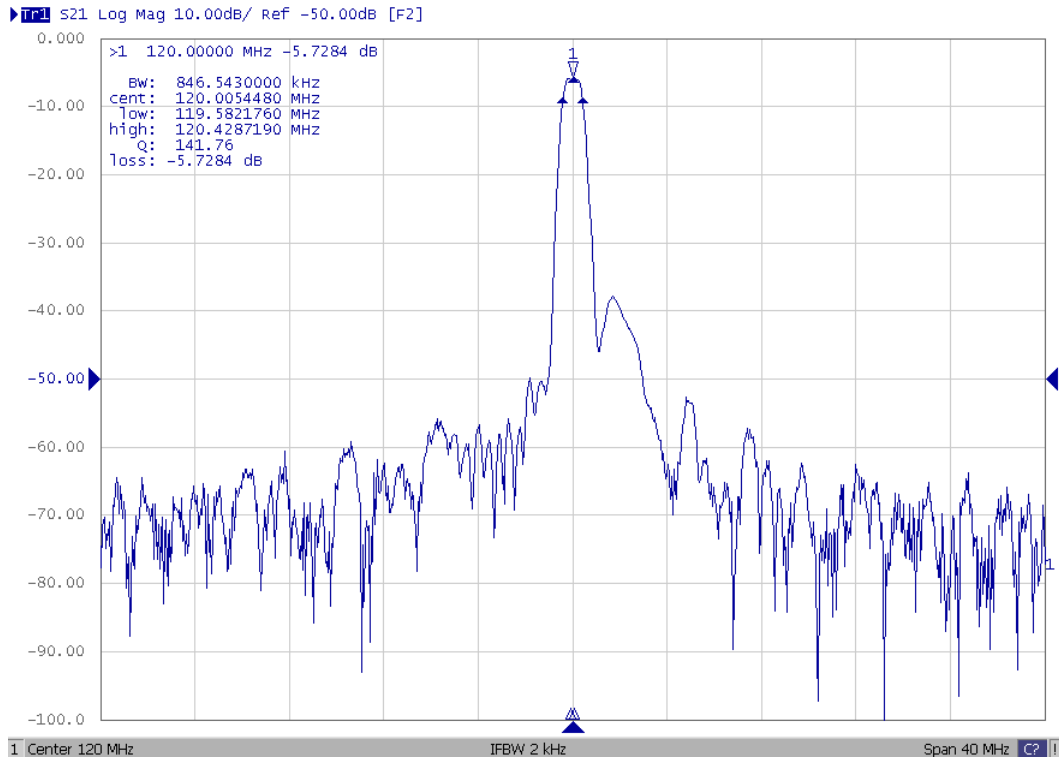

2. Pass Band Response and Group Delay Response:

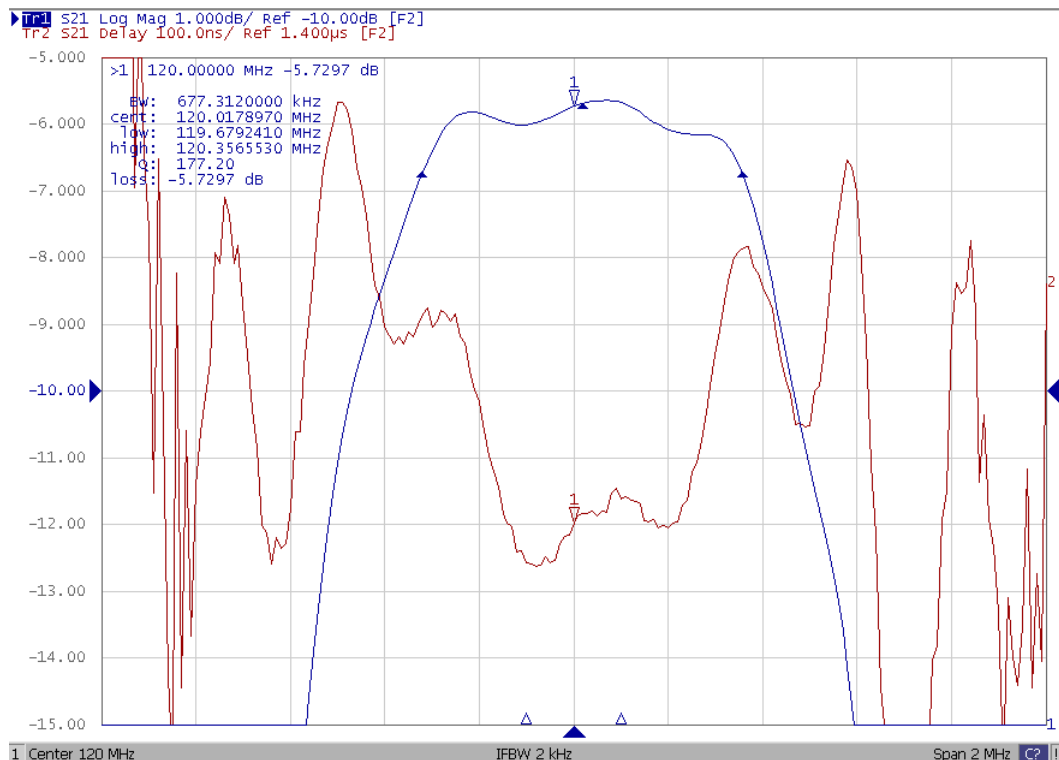

SAW Filter 120.0MHz
Part No: MP09339

Model: TB1314A
Rev No: 1

3. Impedance:

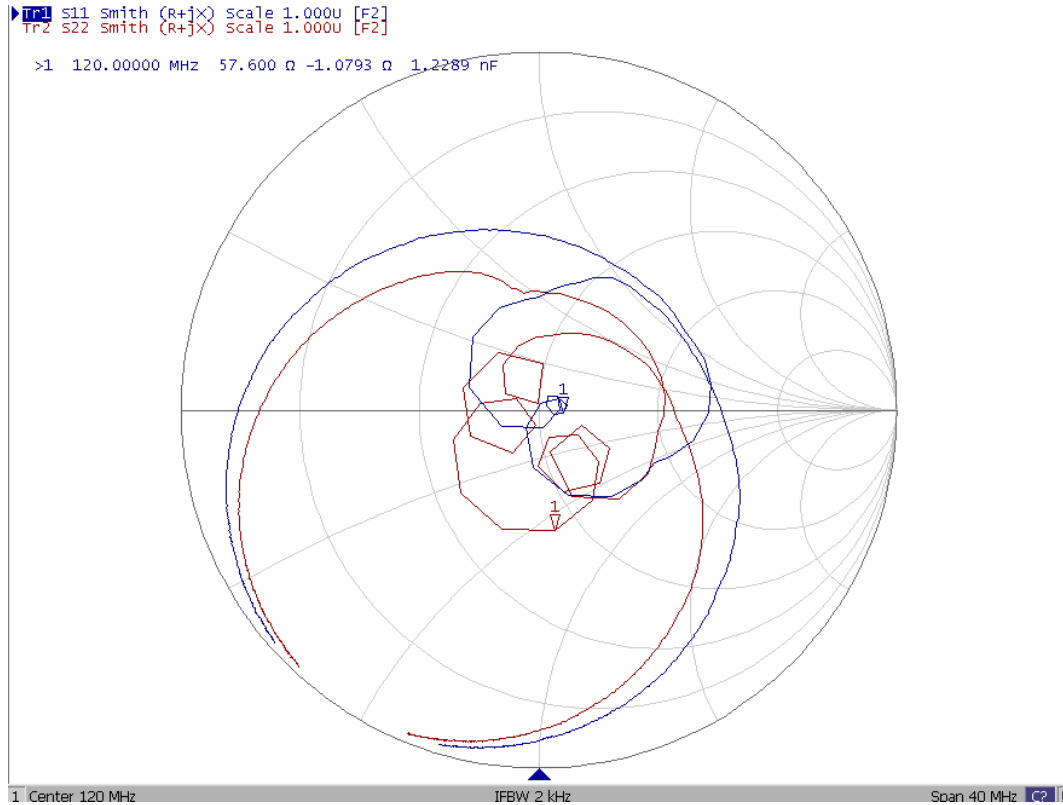

D. MATCHING CIRCUIT:

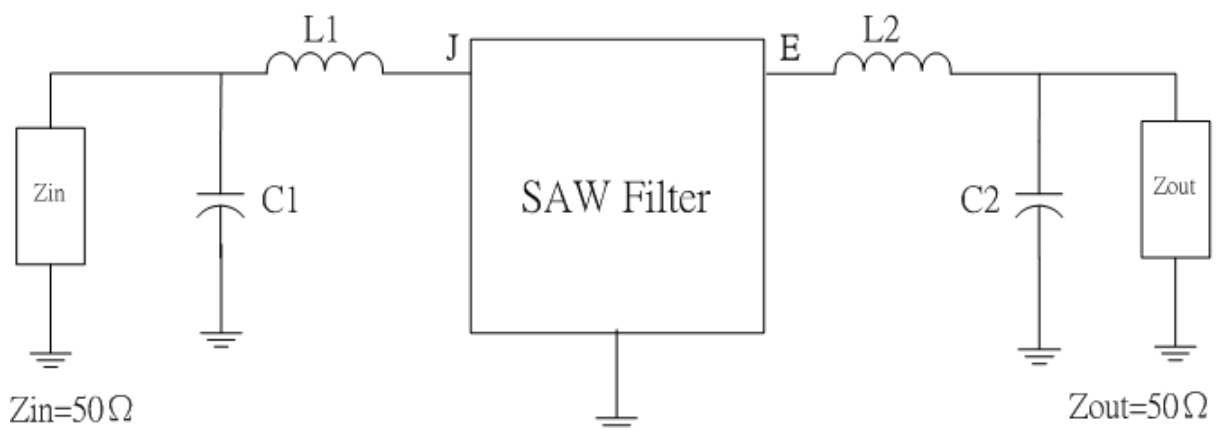

$L1 = 270\text{nH}, L2 = 330\text{nH}, C1 = 39\text{pF}, C2 = 39\text{pF}$

SAW Filter 120.0MHz
Part No: MP09339

Model: TB1314A
Rev No: 1

E. OUTLINE DRAWING:

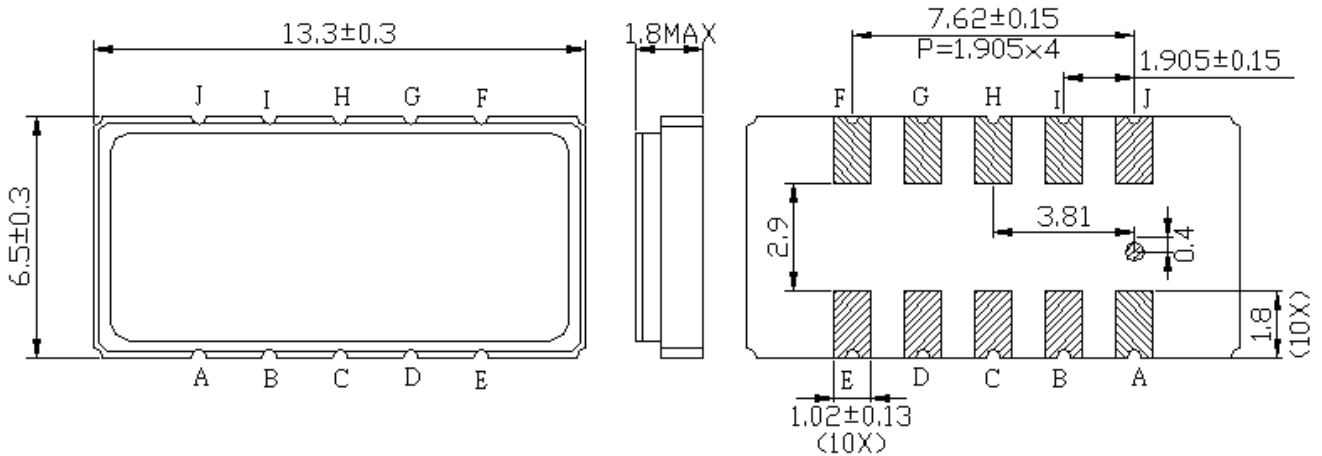

J: Input
 E: Output
 Others: Ground
 Unit: mm

F. PCB FOOTPRINT:

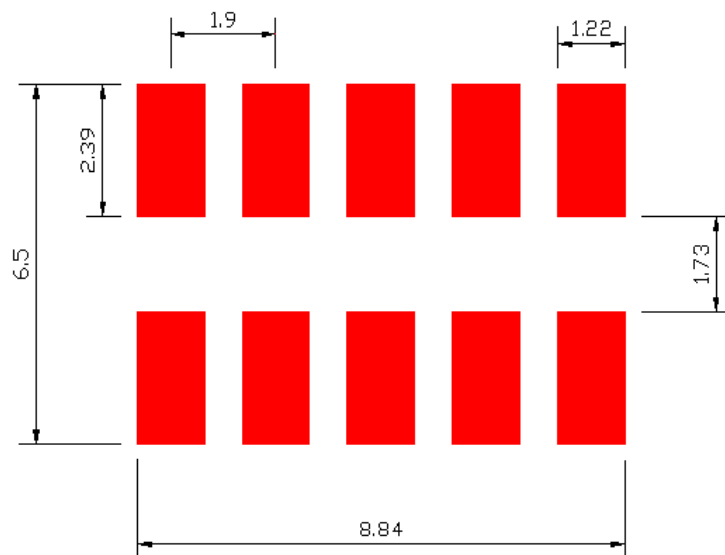

SAW Filter 120.0MHz
Part No: MP09339

Model: TB1314A
Rev No: 1

G. PACKING:

1. Reel Dimension

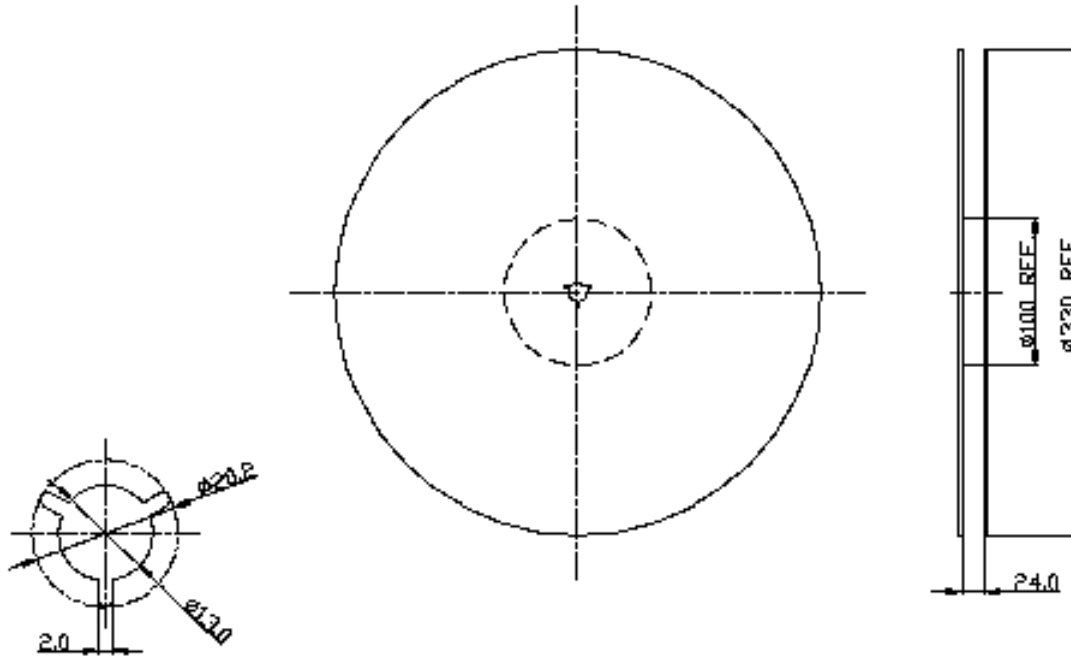

2. Tape Dimension

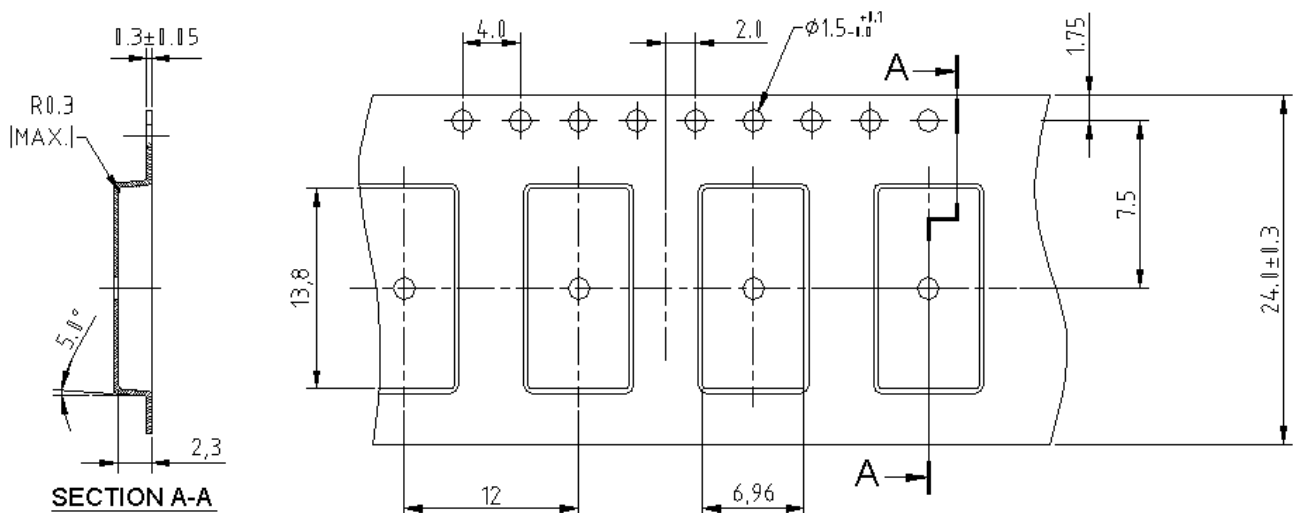

SAW Filter 120.0MHz
Part No: MP09339

Model: TB1314A
Rev No: 1

H. RECOMMENDED REFLOW PROFILE:

1. Preheating shall be fixed at 150 ~ 180°C for 60 ~ 90 seconds.
2. Ascending time to preheating temperature 150°C shall be 30 seconds min.
3. Heating shall be fixed at 220°C for 50 ~ 80 seconds and at 260°C +0/-5°C peak (20 ~ 40 sec).
4. Time: 2 times.

