

**SAW Filter 285MHz**  
**Part No: MP01536**

**Model: TA0486A**  
**REV. NO: 1**

**A. MAXIMUM RATING:**

1. Input Power Level: 0dBm
2. DC voltage: 5 V
3. Operating Temperature: -10°C to +50°C
4. Storage Temperature: -40°C to +85°C

**B. ELECTRICAL CHARACTERISTICS:**

Characteristics	Specification			Note	
	Unit	Min.	Typ.		Max.
Center frequency Fc (MHz)		-	285	-	1
I.L. (Within Fc ± 4 MHz) (dB)		-	2.5	4.5	
Pass band BW <sub>3dB</sub> (MHz)		8.0	12	-	1
Ripple (Within Fc ± 4MHz) (dB)		-	1.2	2.0	1
Attenuation (Reference level from 0dB)					
Fc - 100MHz to -37.5MHz (dB)		48	52	-	1
Fc + 37.5MHz to + 100MHz (dB)		48	52	-	
Impedance at Fc					
Input Z <sub>IN</sub> = R <sub>IN</sub> //C <sub>IN</sub>			150 Ω // 0pF		2
Output Z <sub>OUT</sub> = R <sub>OUT</sub> //C <sub>OUT</sub>			150 Ω // 0pF		2

Note1. The standard definitions is in JIS C 6703

Note2.

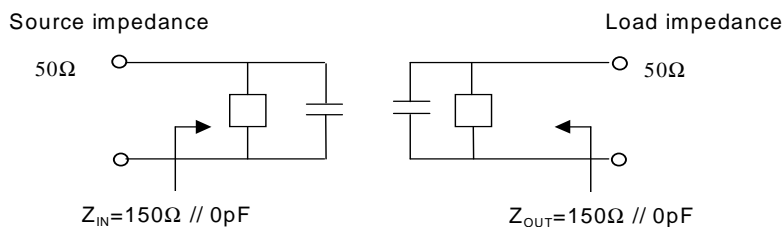

**SAW Filter 285MHz**  
Part No: **MP01536**

**Model: TA0486A**  
REV. NO: 1

**C. FREQUENCY CHARACTERISTICS:**

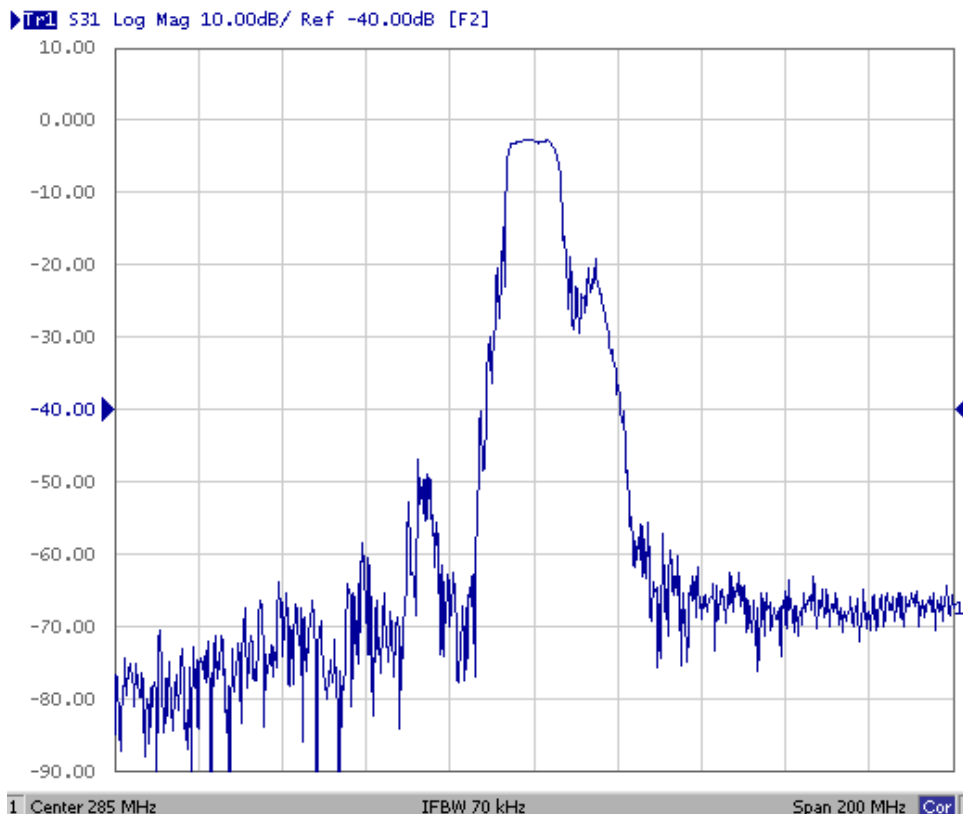
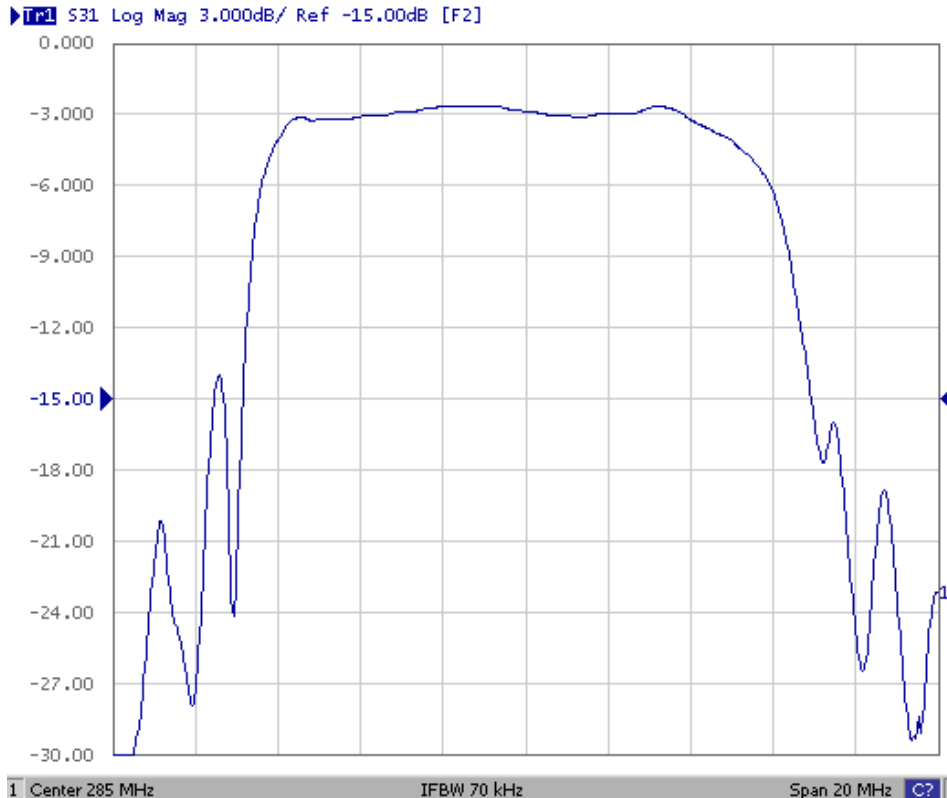

**SAW Filter 285MHz**

**Model: TA0486A**

Part No: **MP01536**

REV. NO: 1

**D. MEASUREMENT CIRCUIT:**

Network analyzer

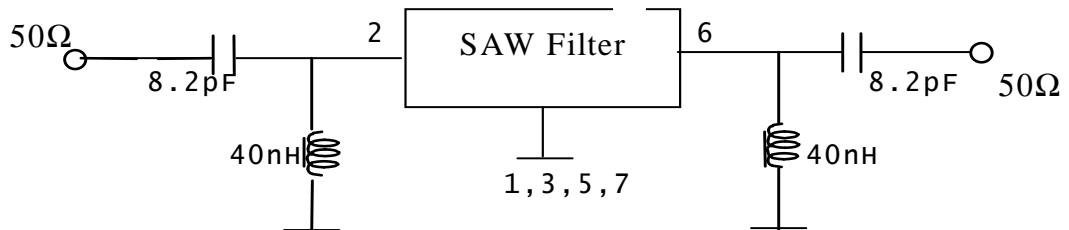

**E. OUTLINE DRAWING:**

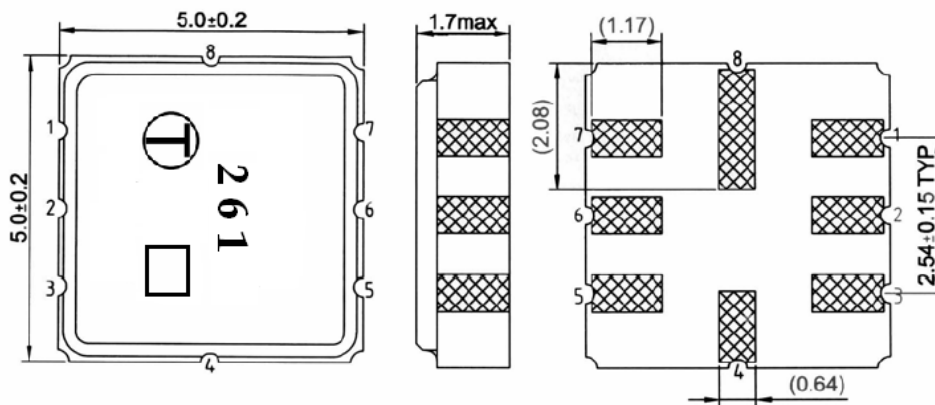

- #2 : Input c
  - #6 : Output o
  - #4、8 : Case Ground
  - #1、3、5、7 : Ground
  - : Date code
- Unit : mm

---

**SAW Filter 285MHz**  
Part No: **MP01536**

**Model: TA0486A**  
REV. NO: 1

---

**F. PCB FOOTPRINT:**

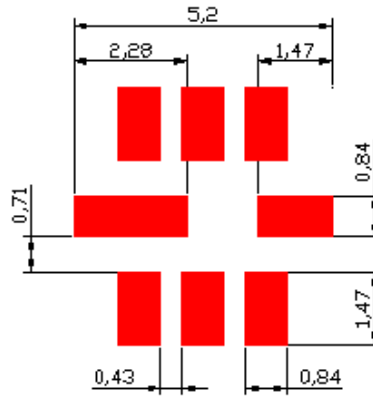

**SAW Filter 285MHz**  
Part No: **MP01536**

**Model: TA0486A**  
REV. NO: 1

**G. PACKING:**

1. REEL DIMENSION

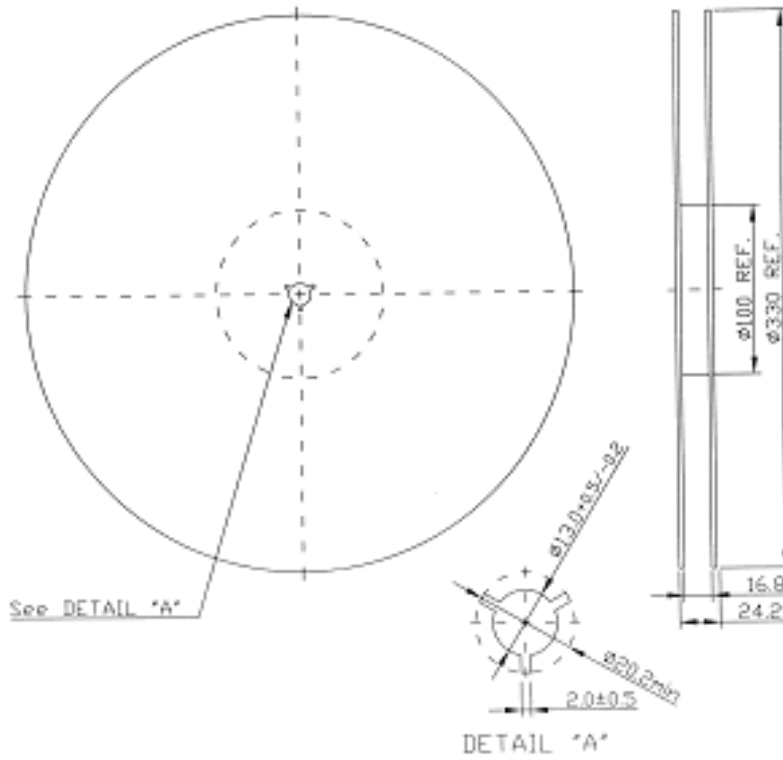

2. TAPE DIMENSION

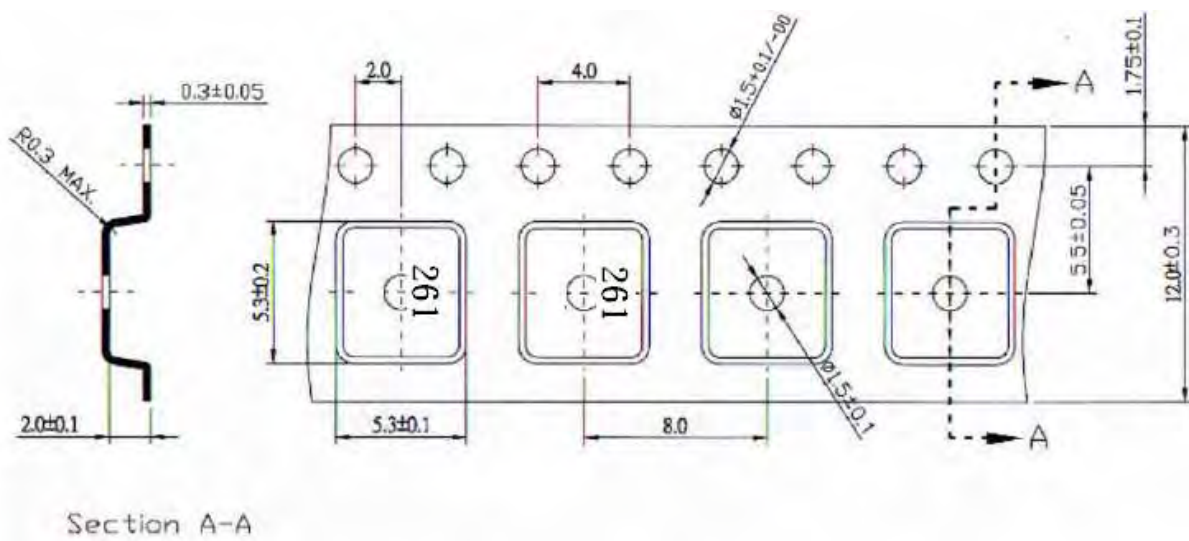

Direction of Feed  
→