

SAW Filter 942.50MHz
Part No: MP08164

Model: TA1839A
Rev No: 1

A. MAXIMUM RATING:

Electrostatic Sensitive Device (ESD)

Operating Temperature: -20°C to +85°C

B. ELECTRICAL CHARACTERISTICS:

1. Terminating source impedance: $Z_S = 50\Omega$ (Single-ended)
2. Terminating load impedance: $Z_L = 50\Omega$ (Single-ended)

Parameters Description		Unit	Min.	Typ.	Max.
Center Frequency		MHz	-	942.5	-
Insertion Loss (*1)	925 ~ 960MHz	dB	-	2.0	3.0
Amplitude Ripple	925 ~ 960MHz	dB	-	1.3	2.3
VSWR	Input				
	925 ~ 960MHz	-	-	1.9	2.3
	Output				
	925 ~ 960MHz	-	-	2.0	2.3
Attenuation:					
880 ~ 915MHz		dB	46	48	-
980 ~ 1558MHz		dB	15	26	-
1559 ~ 1607MHz		dB	40	51	-
1850 ~ 1920MHz		dB	35	44	-
2400 ~ 2500MHz		dB	30	38	-
2775 ~ 2880MHz		dB	28	36	-
3700 ~ 3840MHz		dB	25	32	-
4625 ~ 4800MHz		dB	20	30	-
4900 ~ 5950MHz		dB	18	27	-
5550 ~ 5725MHz		dB	18	27	-
6475 ~ 6720MHz		dB	15	25	-
7400 ~ 7680MHz		dB	15	23	-

(*1) Specification of insertion loss excludes loss that comes from the test board.

SAW Filter 942.50MHz
Part No: MP08164

Model: TA1839A
Rev No: 1

C. FREQUENCY CHARACTERISTICS:

1. Pass-band

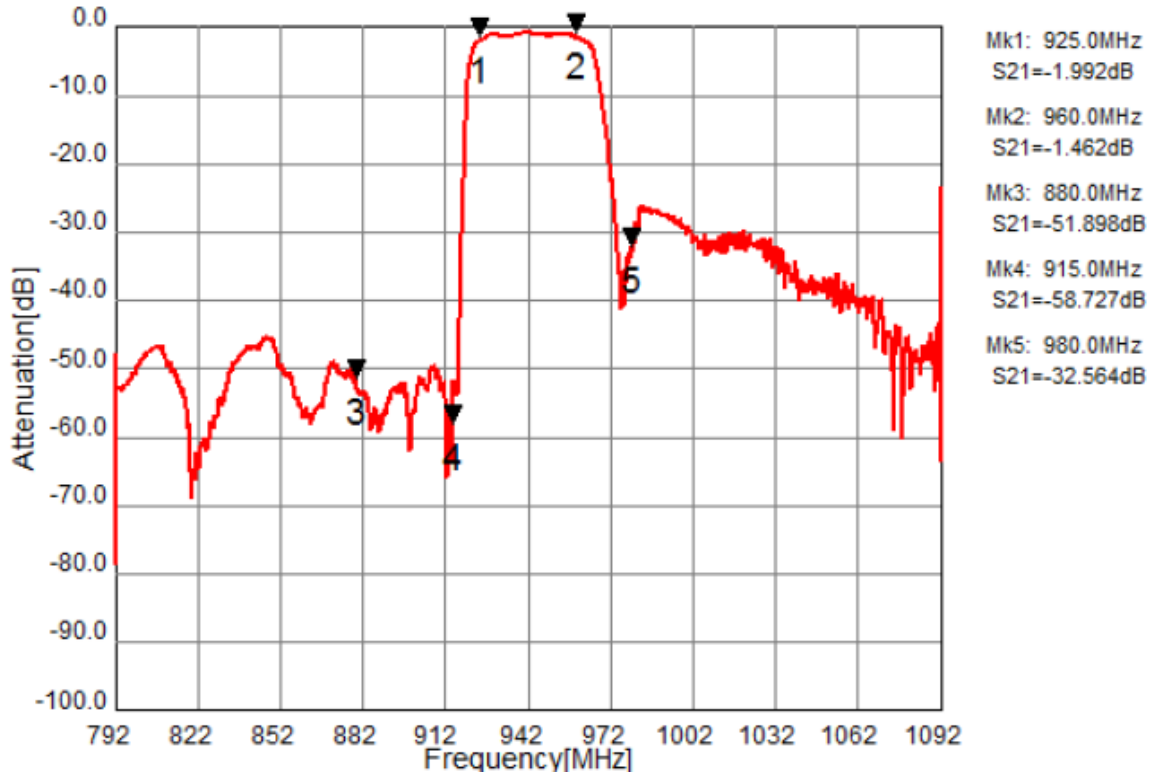

2. In-band

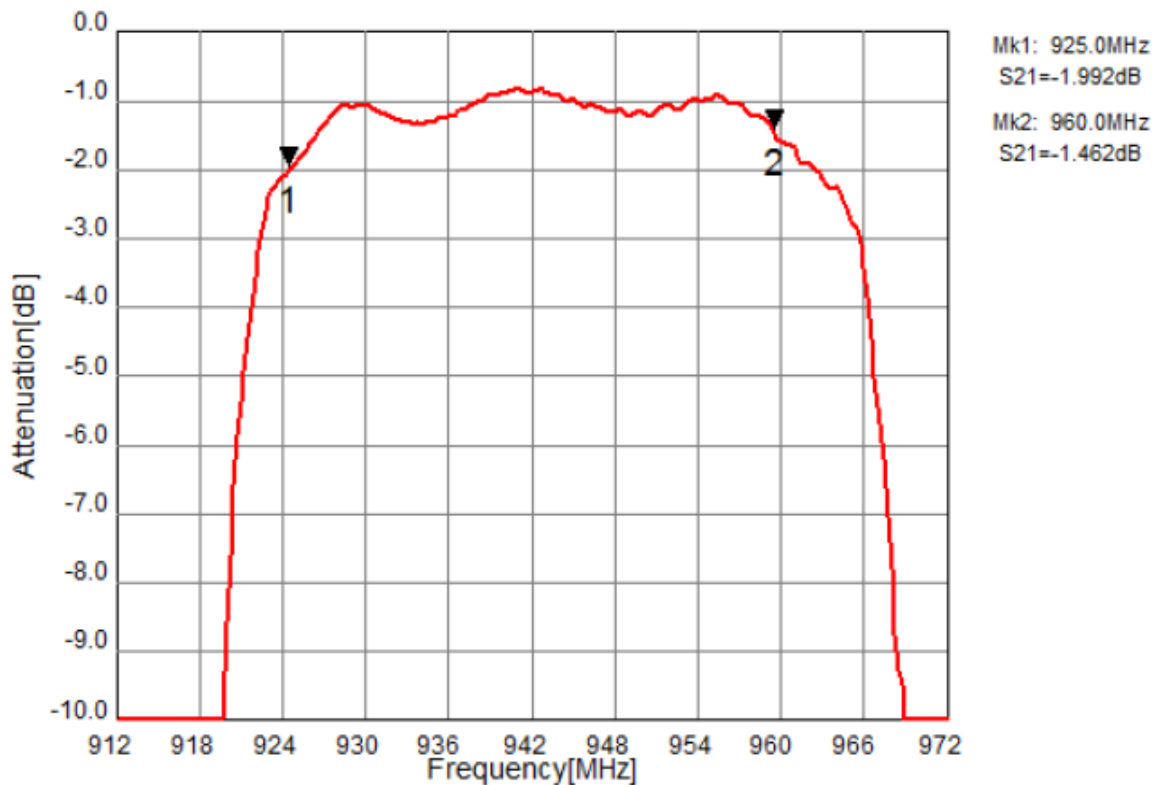

SAW Filter 942.50MHz
Part No: MP08164

Model: TA1839A
Rev No: 1

3. Wide-band

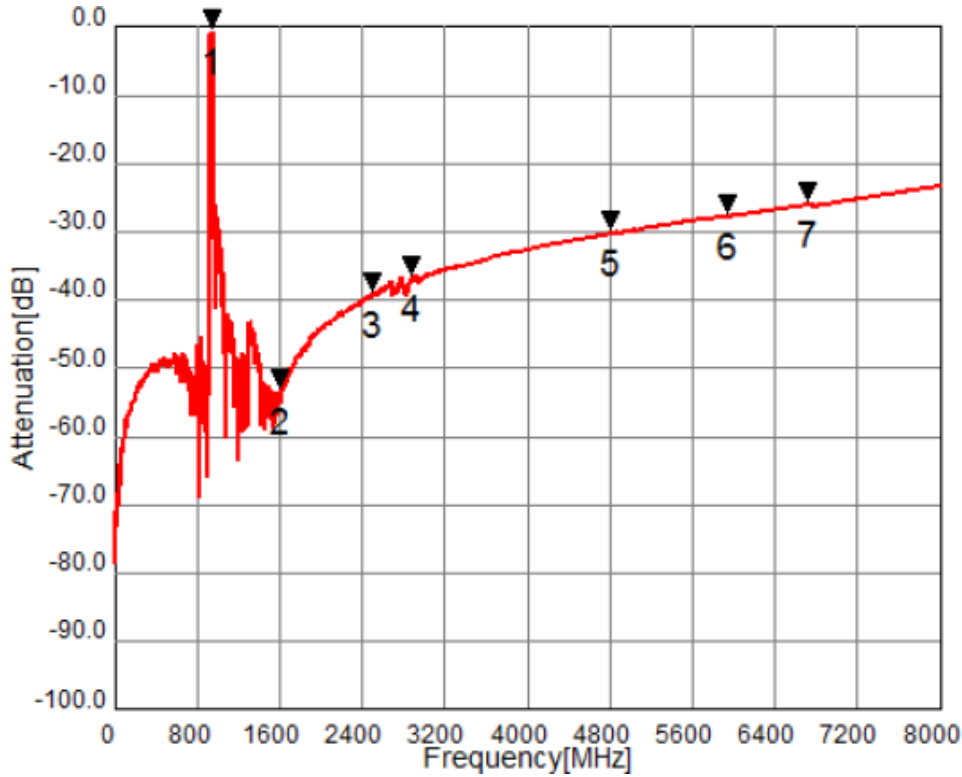

4. VSWR

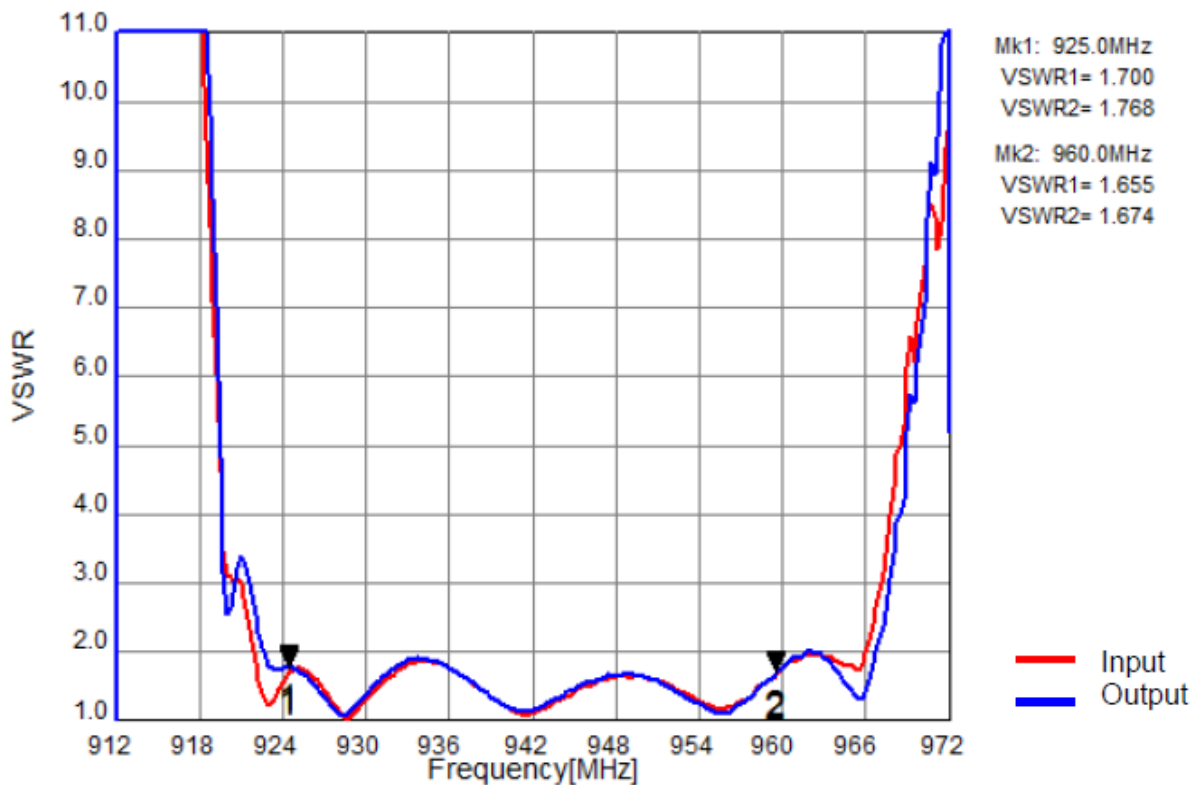

SAW Filter 942.50MHz
Part No: MP08164

Model: TA1839A
Rev No: 1

5. Input Impedance

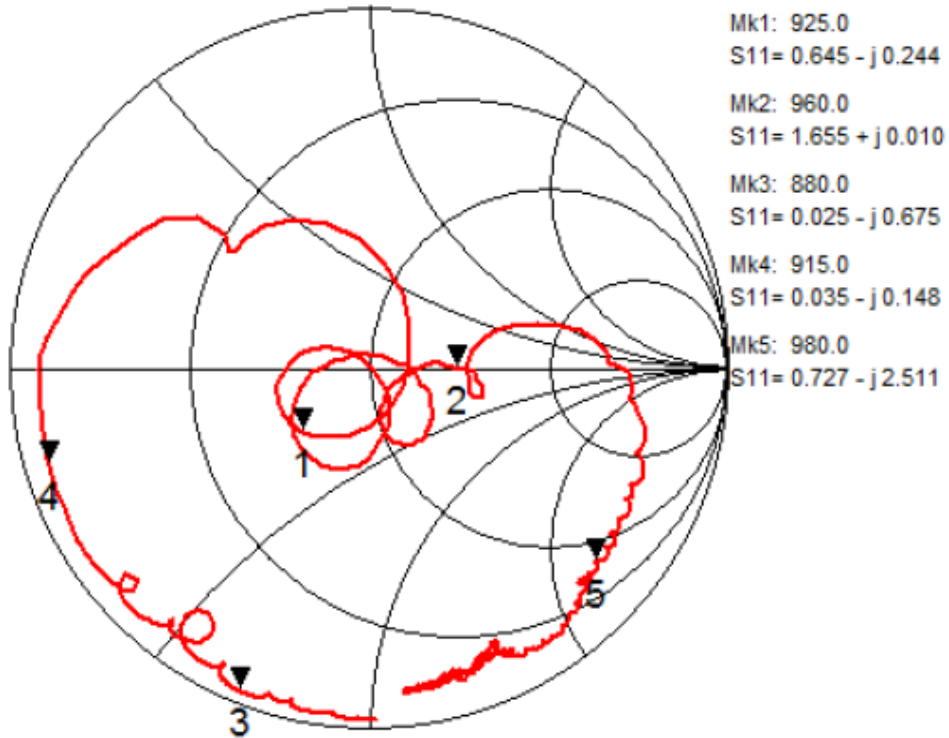

6. Output Impedance

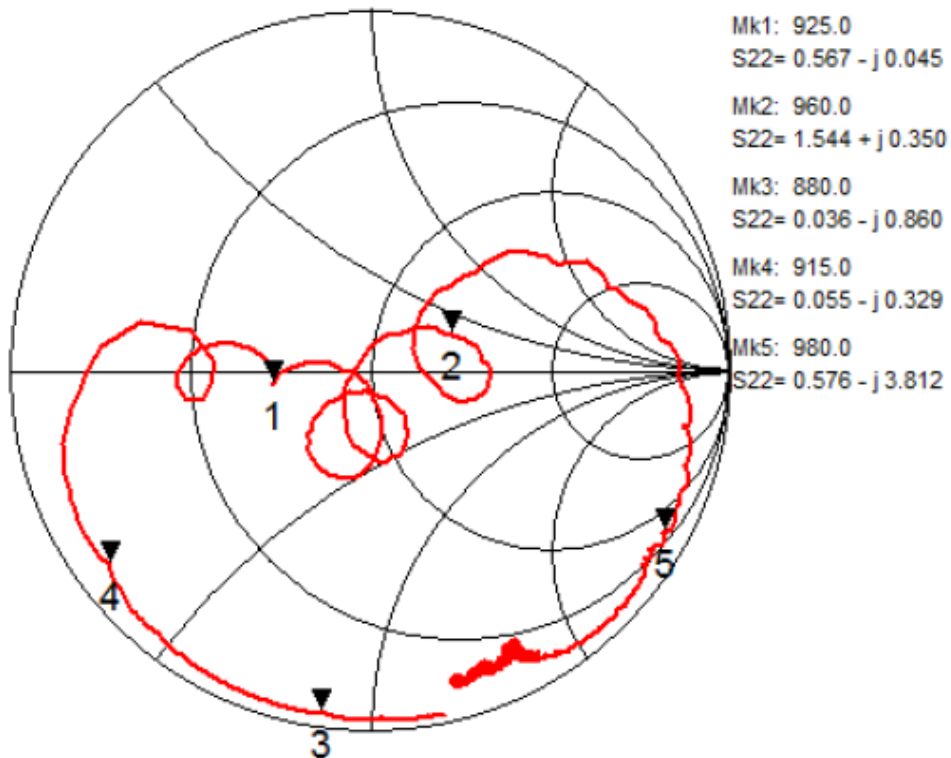

SAW Filter 942.50MHz

Model: TA1839A

Part No: MP08164

Rev No: 1

D. MEASUREMENT CIRCUIT:

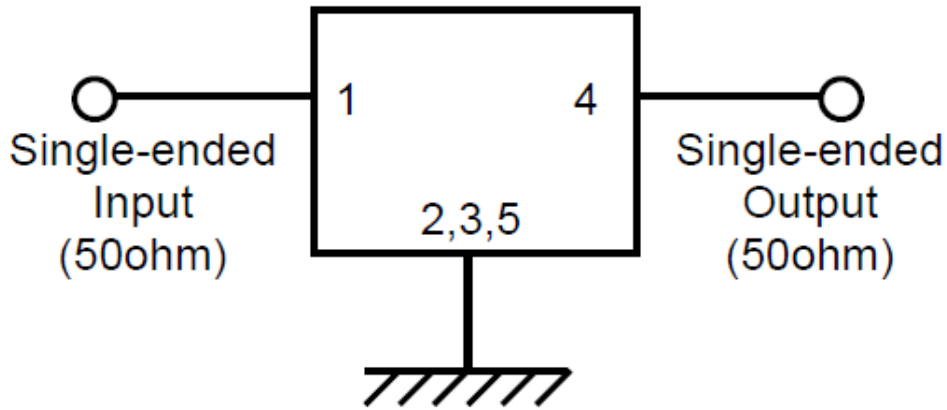

E. OUTLINE DRAWING:

Device size: 1.1typ. x 0.9typ. x 0.5max

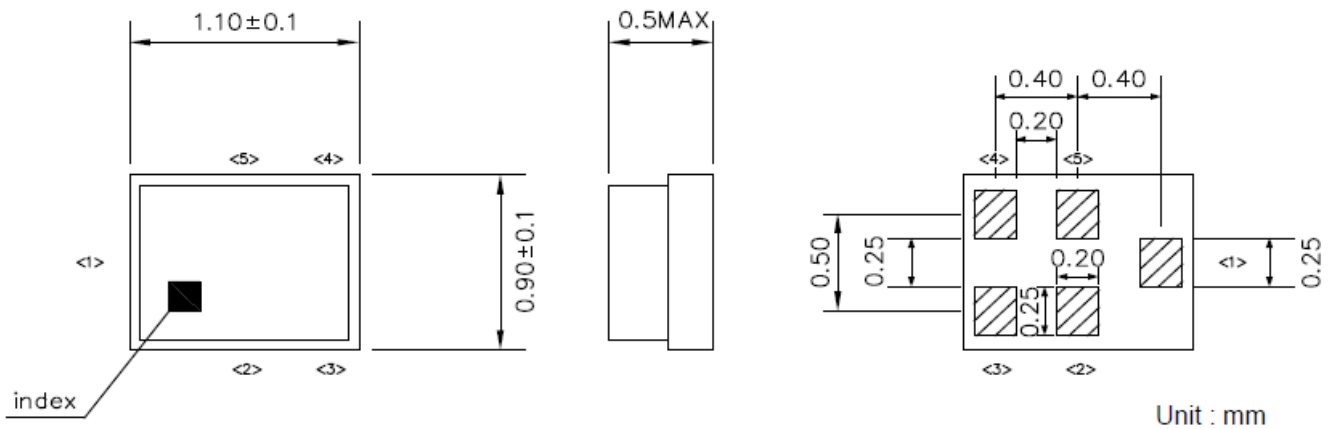

Pin Configuration

Pin No.	Symbol	Function
1	IN	Single-ended pin
2	GND	Ground
3	GND	Ground
4	OUT	Single-ended pin
5	GND	Ground

SAW Filter 942.50MHz
Part No: MP08164

Model: TA1839A
Rev No: 1

F. PACKING:

1. Reel Dimension

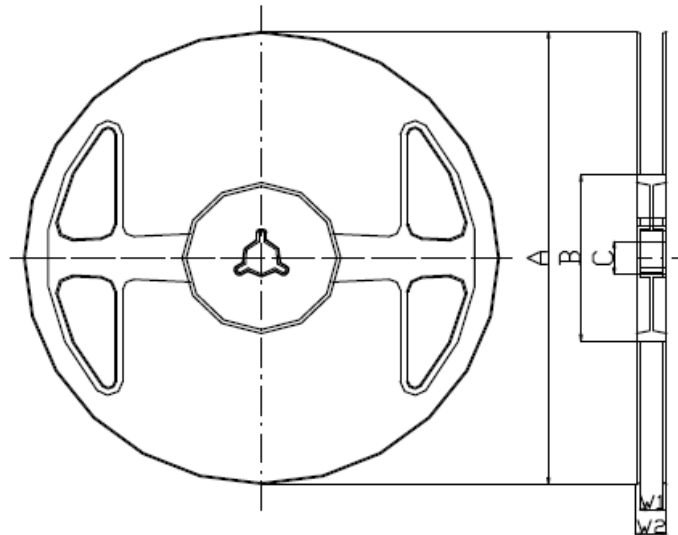

Materials of Reel

Material : Polystyrene + Carbon

Color : Black

Surface resistance (reference value) : $10^9 \Omega/\text{sq}$ Max.

Unit : mm

Code	Quantity	A	B	C	W1	W2
J	5,000 pcs	$\phi 180.0 +0.0/-1.5$	$\phi 66.0 +/-0.5$	$\phi 13.0 +/-0.2$	$9.0 +1.0/-0.0$	$11.4 +/-1.0$

2. Tape Dimension

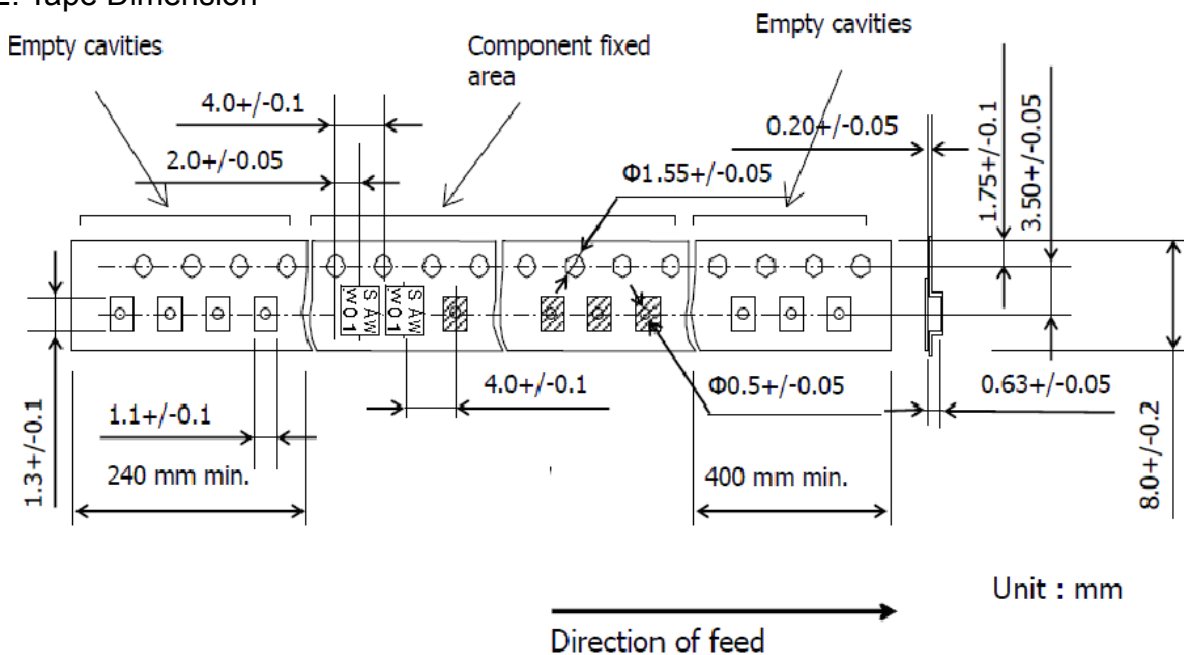

Unit : mm

SAW Filter 942.50MHz
Part No: MP08164

Model: TA1839A
Rev No: 1

G. RECOMMENDED TEMPERATURE PROFILE OF REFLOW SOLDERING:

1. The figure below shows the recommended temperature profile for reflow soldering in the case of lead-free solder alloy Sn3.0Ag0.5Cu.
2. Recommended number of reflow cycles is 5 maximum.
3. Suitable condition for solder heating is different depending on composition and manufacturing method. Please contact the solder manufacturer for details.

